



C6D

干式交流滤波电容器（定制品）

AC-Filter-Capacitor（Customized products）

■ 外形图 Outline Drawing

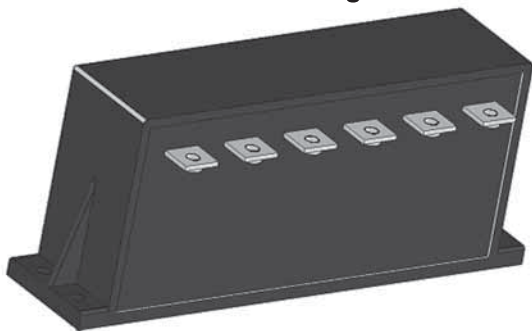

Fig. 1

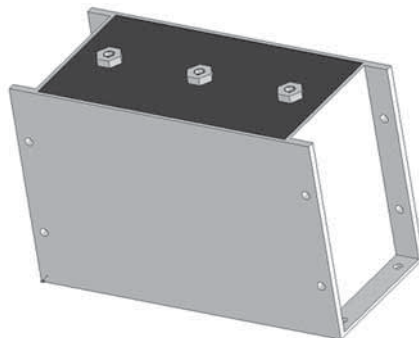

Fig. 2

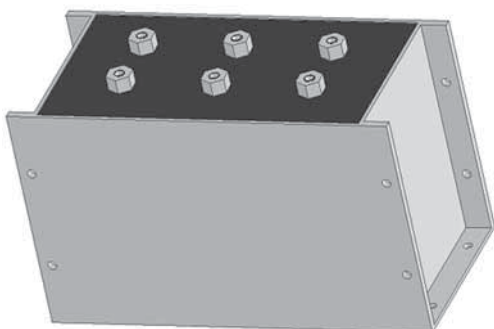

Fig. 3

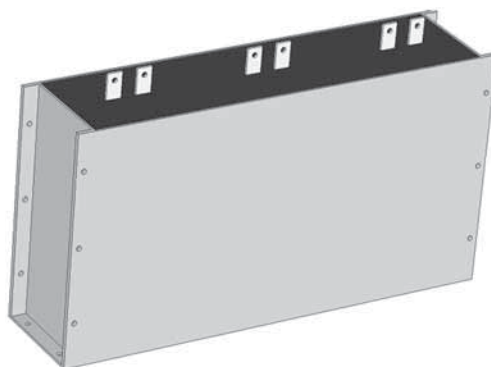

Fig. 4

外壳形状以及电极引出方式仅供用户参考，用户可以按实际需求进行定制，定制包括外形样式以及容量、电压范围；具体要求可以直接与我们联系

The body shape and the electrode terminals are only for users reference, users can customize according to the actual demand, customization include appearance style, capacity and voltage range; Contact with us directly if any specific requirements.

■ 特点

- 应用于交流滤波电路中
- 等效串联电阻小，能承受大的谐波电流
- 自感小
- 有自愈性
- 寿命长
- 树脂灌封

■ 应用场合

- 风能发电、太阳能发电用变频器上的交流滤波
- 交通工具，如：电动车和混合动力车的充电部分滤波
- 焊接设备，电梯，电机驱动

■ 技术参数 Technical data

■ Features

- Used in AC-Filter circuits
- Low ESR, high harmonic current handling capabilities
- Low ESL
- Self-healing property
- Long lifetime
- Filled with resin

■ Applications

- Used in Inverters of wind power and solar power for AC-Filter
- Transportation: For HEV or EV charging circuit
- Welders, Elevators, Motor Driver systems

引用标准 Reference Standard	IEC 61071, GB/T 17702
气候类别 Climatic Category	40/85/21
工作温度范围 Operating temperature range	-40℃ ~ 70℃ $\Theta_{hs} \leq 85^\circ\text{C}$

存储温度范围 Storage temperature range	-40℃ ~ 85℃	
电容量允许偏差 Capacitance Tolerance	±5% (J) , ±10% (K)	
额定电压 (U _{rms}) Rated voltage	230Vac ~ 850Vac (可根据用户需求 According to customer requirements)	
额定容量 (C _N) Rated capacity	可根据客户需求 According to customer requirements	
耐电压 Voltage Proof	极间 Between Terminals:	1.5U _N 或 2.15U _{rms} (10s, 20℃ ± 5℃)
	极壳之间 Between Terminals And Case:	3 000Vac(10s, 50Hz, 20℃ ± 5℃)
介质损耗 tg δ ₀	0.0002	
R _i × C _N	≥ 5 000s (20℃ ,100V)	
保护等级 Degree of protection	IP00, indoor mounting	
预期寿命 Expected Lifetime	50 000hours (U _{rms} , Θ _{hs} <70℃)	
失效率 Failure rate	300FIT	
最高海拔 Max Altitude	2 000m	

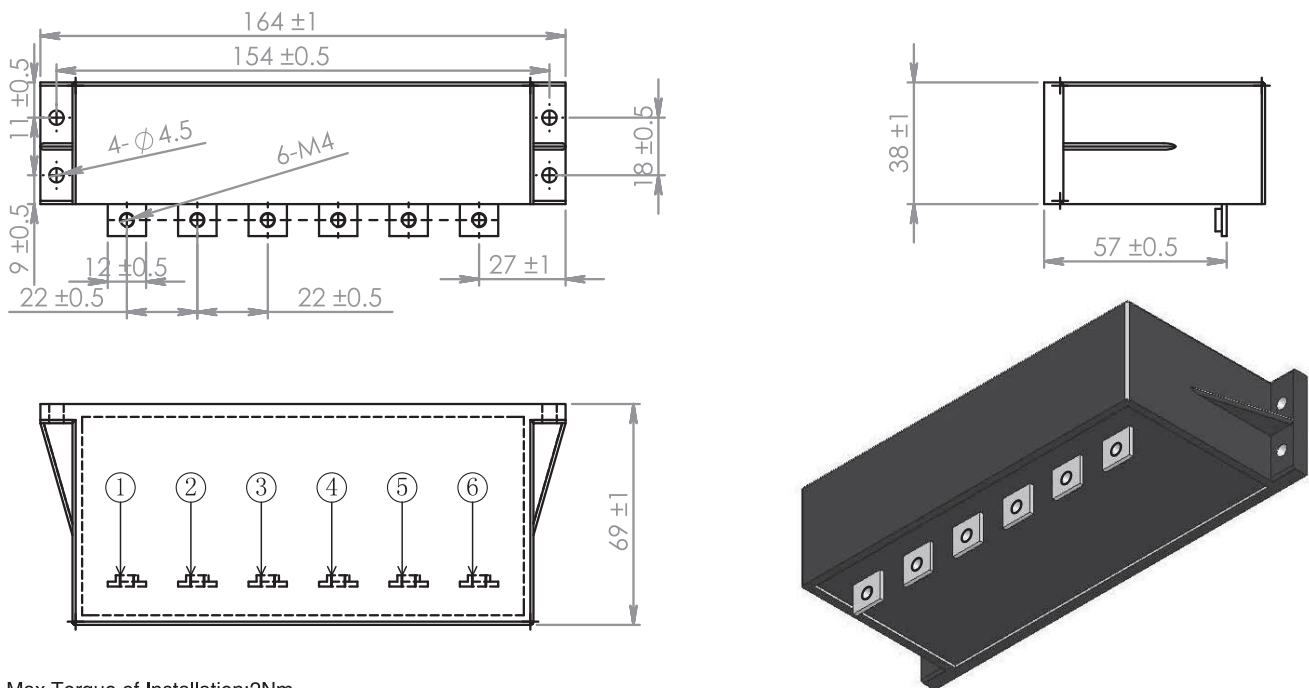

Max Torque of Installation:2Nm

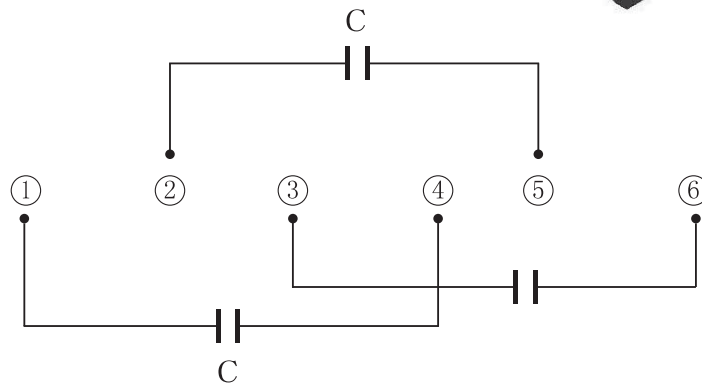

U_{rms}=310Vac U_N=450Vac

C _N (μF)	R _s (mΩ)	L _s (nH)	R _{th} (℃/W)	I _{max} (A)	I _h (kA)	I _s (kA)	Case	Type	M (kg)	Part number
3 × 25	3 × 10	100	6.7	3 × 15	0.75	2.25	Plastic	Fig.1	0.6	C6DQ3256K0*****

注：本定制产品适用于电压小于250VAC的滤波系统 This customized part is suitable for the voltage less than 250Vac filter system



C6D

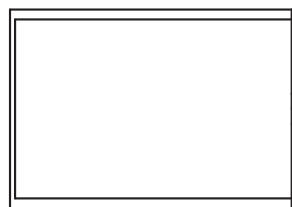
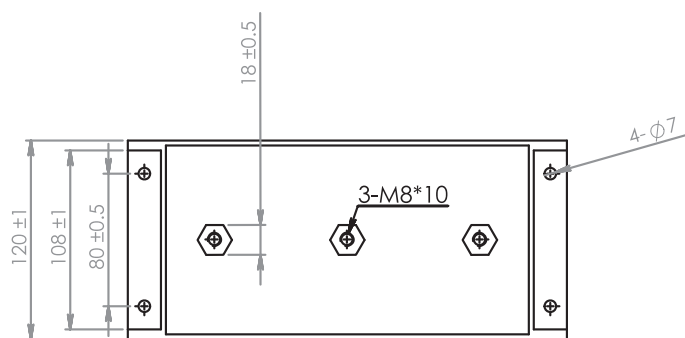
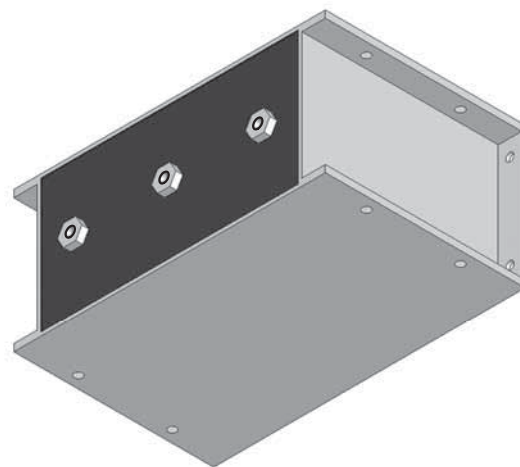
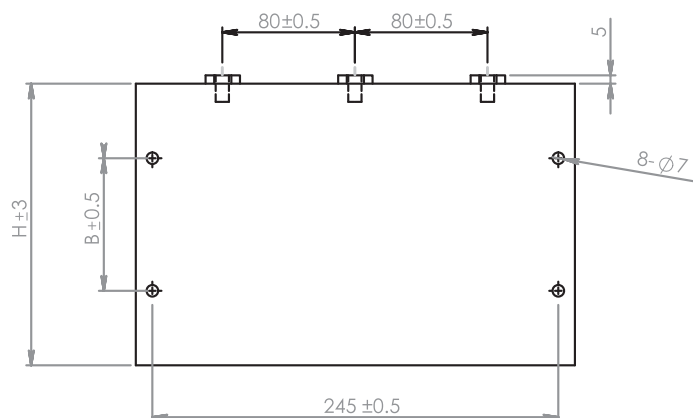

Max Torque of Installation: 5Nm

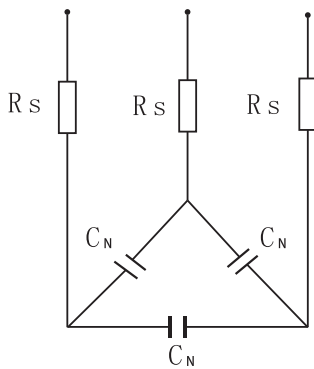

Circuit diagram

$U_{rms}=450Vac$ $U_N=630Vac$

C_N (μF)	H (mm)	B (mm)	R_s (m Ω)	L_s (nH)	R_{th} ($^{\circ}C/W$)	I_{max} (A)	\hat{I} (kA)	\hat{I}_s (kA)	Case	Type	M (kg)	Part number
3 × 100	100	50	3 × 1.5	100	1.6	3 × 70	1.1	3.3	Al	Fig.2	3.6	C6DS2107J0*****
3 × 200	170	80	3 × 0.8	110	1.2	3 × 80	2.7	8.1	Al	Fig.2	6.5	C6DS2207J0*****

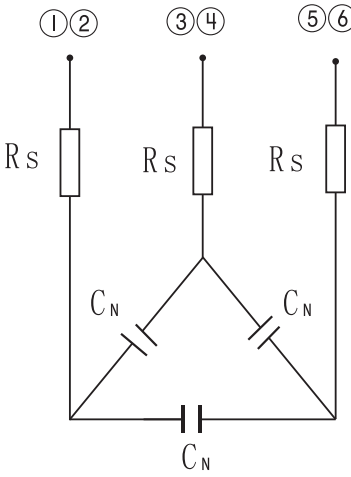
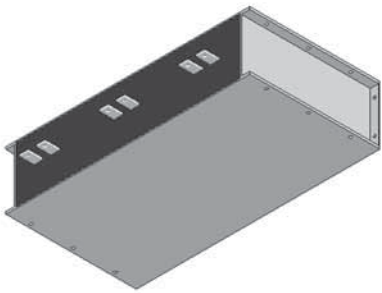
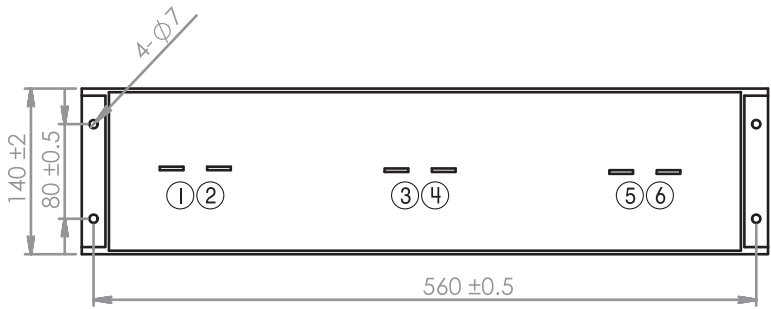
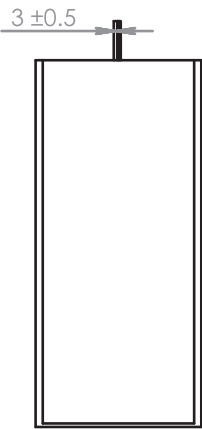
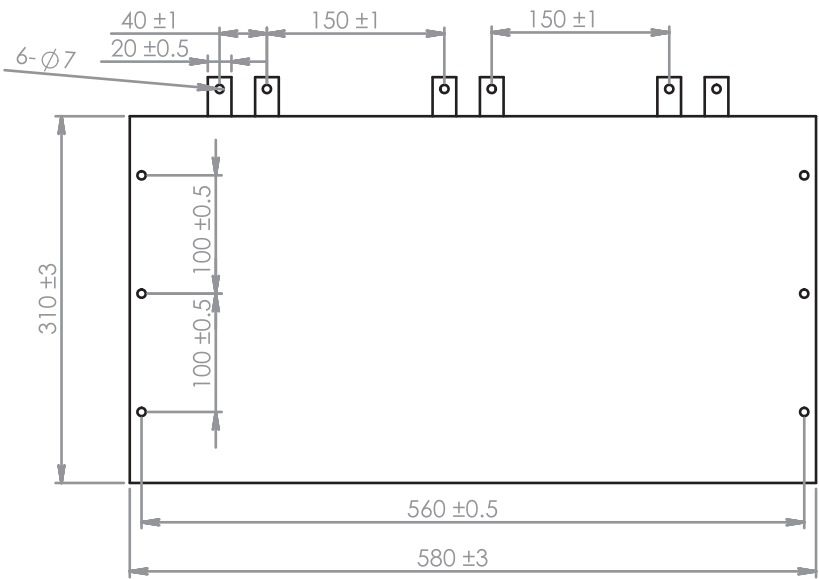

Circuit diagram

$U_{rms}=480Vac$ $U_N=680Vac$

C_N (μF)	R_s ($m\Omega$)	L_s (nH)	R_{th} ($^{\circ}C/W$)	I_{max} (A)	\hat{I} (kA)	\hat{I}_s (kA)	Case	Type	M (kg)	Part number
3×600	3×0.5	100	0.3	3×220	20.6	61.5	Al	Fig.4	32	C6DS3607J0*****



C6D

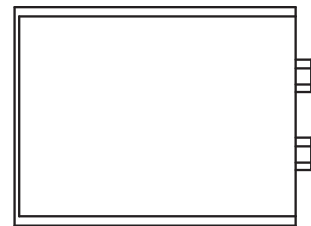
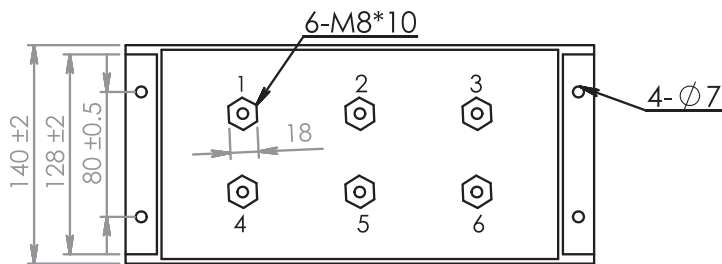
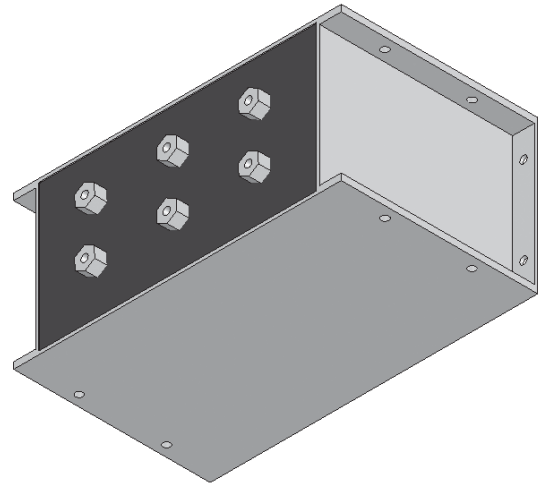
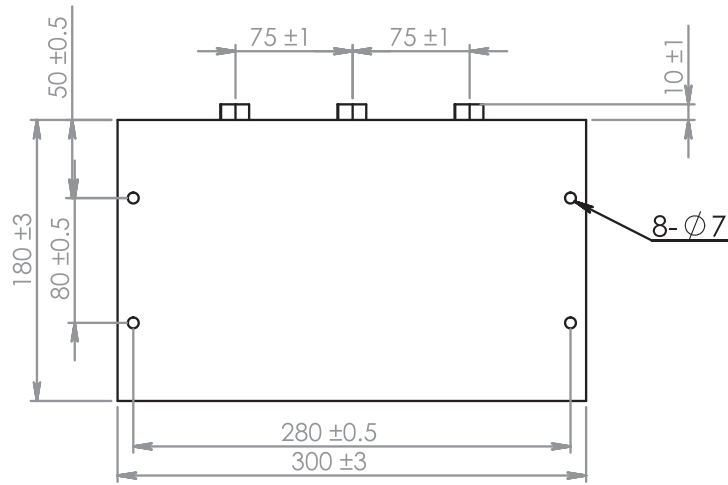

Max Torque of Installation:5Nm

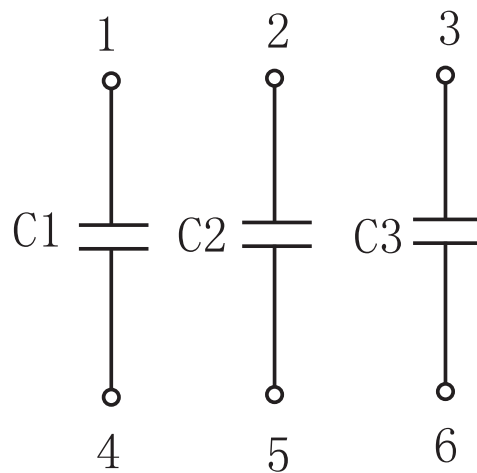

$C1=C2=C3=56\mu F$

$U_{rms}=850V_{ac}$

C_N (μF)	R_s ($m\Omega$)	L_s (nH)	R_{th} ($^{\circ}C/W$)	I_{max} (A)	\hat{I} (kA)	\hat{I}_s (kA)	Case	Type	M (kg)	Part number
3 × 56	3 × 1.0	100	1.0	3 × 71	3.0	9.0	Al	Fig.3	8.5	C6DW1566J0*****